

Art. No.  
**1069**

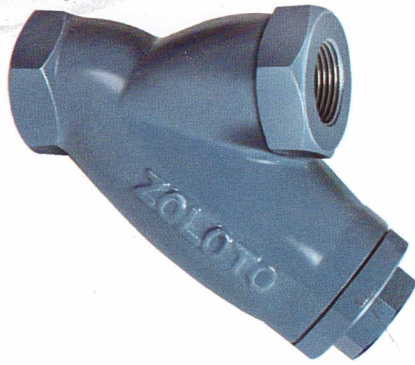

**ZOLOTO®**  
CAST IRON  
Y-TYPE  
STRAINER  
(Screwed)



**SALIENT FEATURES :**

- Screwed Female ends to BSPT.
- Stainless Steel (AISI 304)/ Brass (IS 410) 1mm diameter hole perforated sheet screen is guided in body & bonnet.
- Fine finish and smooth contours to minimize pressure drop inside the strainer.
- Large screening area makes the strainer highly efficient in performance.

**SUITABLE FOR**

Steam	Water	Oil	Air	Gases
◆	◆			

**MATERIALS :**

Name of Part	Material	Specification
Body & Bonnet	Cast Iron	IBR 86-93 Gr. A
Screen	S.S/ Brass	AISI 304/ IS 410
Gasket	Steam Jointing Sheet	IS 2712 Gr. W/3

**SIZE:**

Inches	mm	DIMENSIONS:	
		A	B
1/2	15	76	71
3/4	20	98	85
1	25	133	95
1¼	32	155	110
1½	40	178	116
2	50	222	140

**DIMENSIONS:**

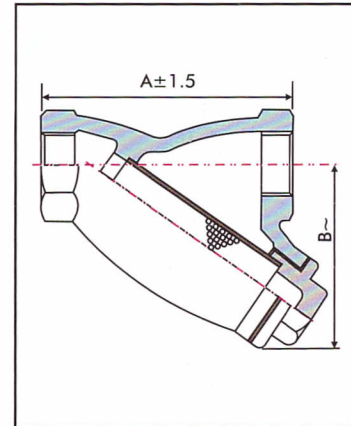

Test Pressure (Hydraulic) 21.10kg/cm<sup>2</sup>g (300psig) Working Pressure (Steam) 10.55kg/cm<sup>2</sup>g (150psig) Max. Working Temperature 220°C

Art. No.  
**1070**



**ZOLOTO®**  
CAST IRON  
Y-TYPE  
STRAINER  
(Flanged)



**SALIENT FEATURES :**

- Flanged ends to BS 10 table 'F'.
- Stainless Steel (AISI 304) Brass (IS 410) 1mm diameter hole perforated sheet screen is guided in body & cover.
- Drain plug is provided to remove the accumulated foreign particles.
- Fine finish and smooth contours to minimize pressure drop inside the strainer.
- Large screening area makes the strainer extremely efficient in performance.

**SUITABLE FOR**

Steam	Water	Oil	Air	Gases
◆	◆			

**MATERIALS :**

Name of Part	Material	Specification
Body & Cover	Cast Iron	IBR 86-93 Gr. A
Drain Plug	Bronze	IBR 282 (a) (iv) Gr. B
Screen	S.S/ Brass	AISI 304/ IS 410
Gasket	Steam Jointing Sheet	IS 2712 Gr. W/3
Stud & Nut	Carbon Steel	IS 1367

**SIZE:**

Inches	mm	DIMENSIONS:	
		A	B
1/2	15	136	87
3/4	20	140	90
1	25	162	112
1¼	32	185	135
1½	40	206	152
2	50	210	205
2½	65	248	250
3	80	270	268
4	100	381	290

**DIMENSIONS:**

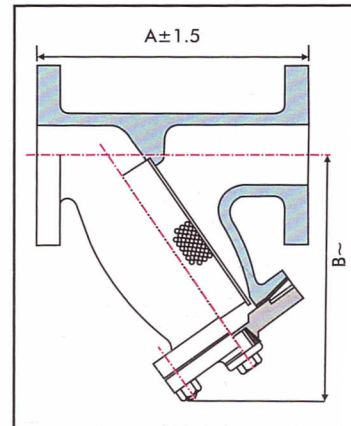

Test Pressure (Hydraulic) 21.10kg/cm<sup>2</sup>g (300psig) Working Pressure (Steam) 10.55kg/cm<sup>2</sup>g (150psig) Max. Working Temperature 220°C